

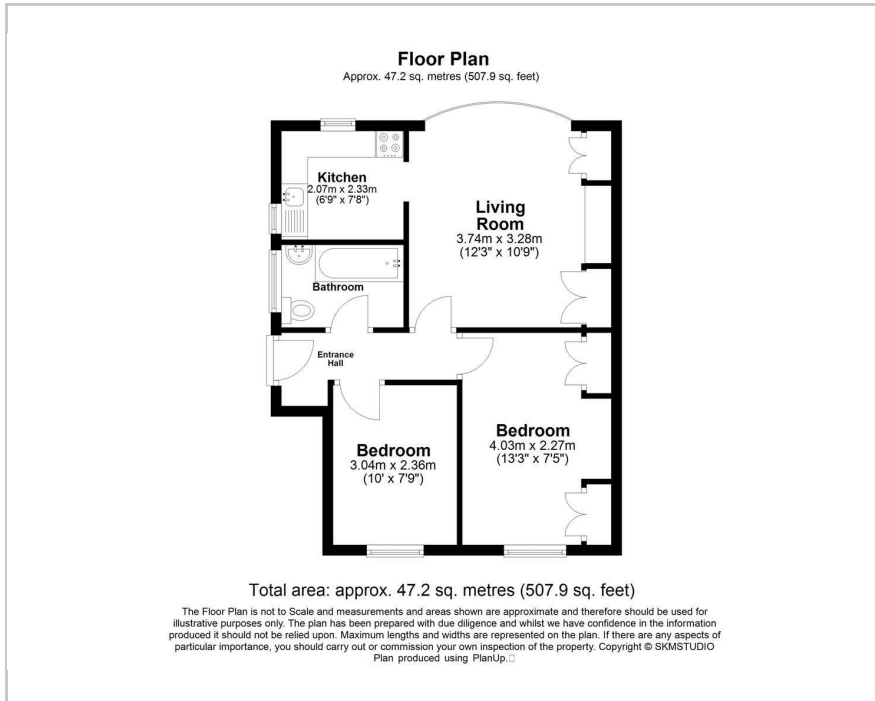

47 Malvern Way, Croxley Green, WD3 3QQ
Price Guide £365,000



Floor Plan



Area Map

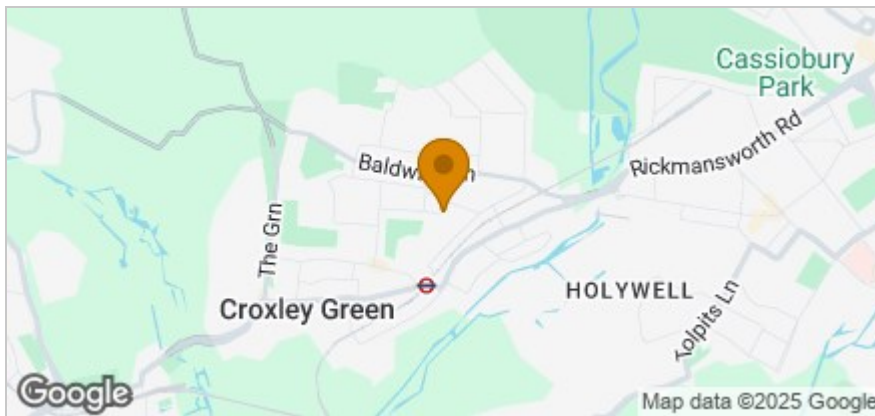

Accommodation

- Ground floor 2 bed maisonette
- Large reception room open plan to lovely galley kitchen
- Front garden and private garden to the side/rear
- Stones throw from the Met Line station
- Next to an outstanding junior school
- Central village location
- 111 years remaining on the lease

Viewing

Please contact our Grosvenor Estate Agents Ltd Office on 01923 711651 if you wish to arrange a viewing appointment for this property or require further information.

Energy Efficiency Graph

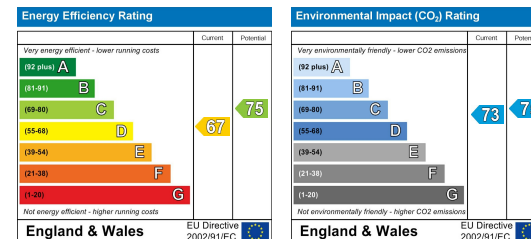

These particulars, whilst believed to be accurate are set out as a general outline only for guidance and do not constitute any part of an offer or contract. Intending purchasers should not rely on them as statements of representation of fact, but must satisfy themselves by inspection or otherwise as to their accuracy. No person in this firm's employment has the authority to make or give any representation or warranty in respect of the property.